

£16,000 + VAT per year
1 acre secured, serviced
Upper Yard
Mount Wellington Mine



Mount Wellington Mine Limited T:01872 862632
Fernsplatt | Chacewater | Truro | Cornwall | TR4 8RJ
www.mountwellington.co.uk info@mountwellington.co.uk

**1 ACRE (APPROX) SECURE YARD—3 MILES FROM THE A30
FULLY SERVICED — ELECTRICITY, WATER, SEWAGE
CONCRETE BASE FOR PORTAKABIN OFFICE
PRIVATE, GATED YARD
COULD STORE AROUND 40 SHIPPING CONTAINERS OR 20 HGV
FLEXIBLE LEASE TERMS - AVAILABLE IMMEDIATELY
£16,000 + VAT PER YEAR**



Description

An unused car park with a host of flexible uses, subject to planning consents that is convenient for the A30, Truro, Falmouth and Redruth. The yard is offered by way of a new proportional repairing and insuring lease.

Location

Located just 3 miles South of the A30, Mount Wellington Mine, one of Cornwall's 'big 4' modern tin mines, is now a highly desirable redeveloped business park. Other occupiers have included Kensa Heat Pumps, Geoquip Marine, R-Eco, Wind Lens, Kraft Maus and Minus Engineering.

Schedule of Accommodation

All areas and dimensions are approximate.

There is room for a Portakabin or shipping container type office with bathroom. There is parking for around 20 articulated lorries or 40 shipping containers.

Lease Terms

The premises are offered by way of a new proportional full repairing and insuring lease, the terms of which are open to negotiation.

Legal Costs

The ingoing lessee to bear the landlord's reasonably incurred legal costs in connection with the transaction or modification of site.

Disclaimer

All drawings and maps are not to scale and for identification of the property only. They are not intended to show actual site boundaries and not guaranteed to be accurate.

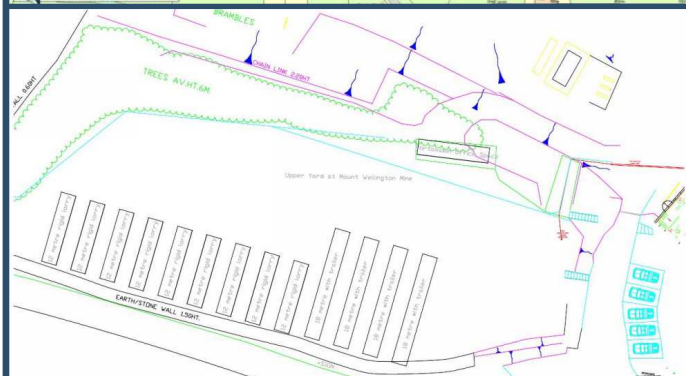
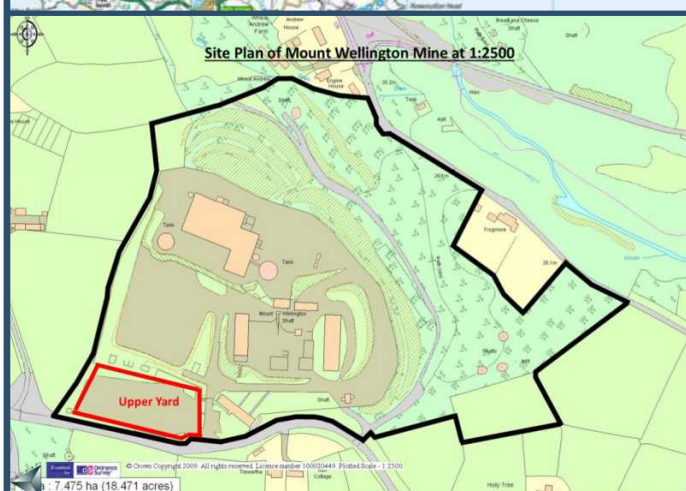

**Mount Wellington Mine Limited T:01872 862632
Fernsplat | Chacewater | Truro | Cornwall | TR4 8RJ
www.mountwellington.co.uk info@mountwellington.co.uk**